

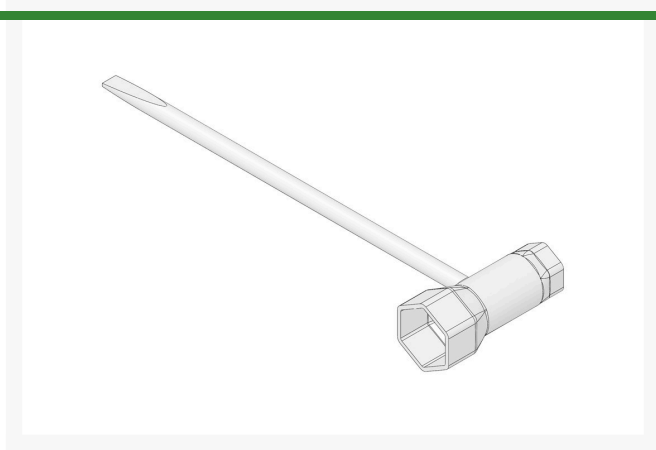

Srench Chainsaw Tool Wrench

R57-005



Details

This 13mm x 19mm ((1/2 in. x 3/4 in.) Srench tool is used for adjusting the chain tension on a chain saw, removing the spark plug and even accessing air filters and starters on many saws. The Srench does the job of two wrenches and a screwdriver. It also works on many small gas engines and powered string trimmers and leaf blowers. Barrel Size 13x19mm (1/2 x 3/4 in.)

Specifications

Manufacturer	R&R Products
Dimensions	13mm x 19mm

TURF Handels GmbH

Am Hartboden 48 Gratkorn, 8101

+43 3124 29064-17

<https://turf.rrproducts.com/>