

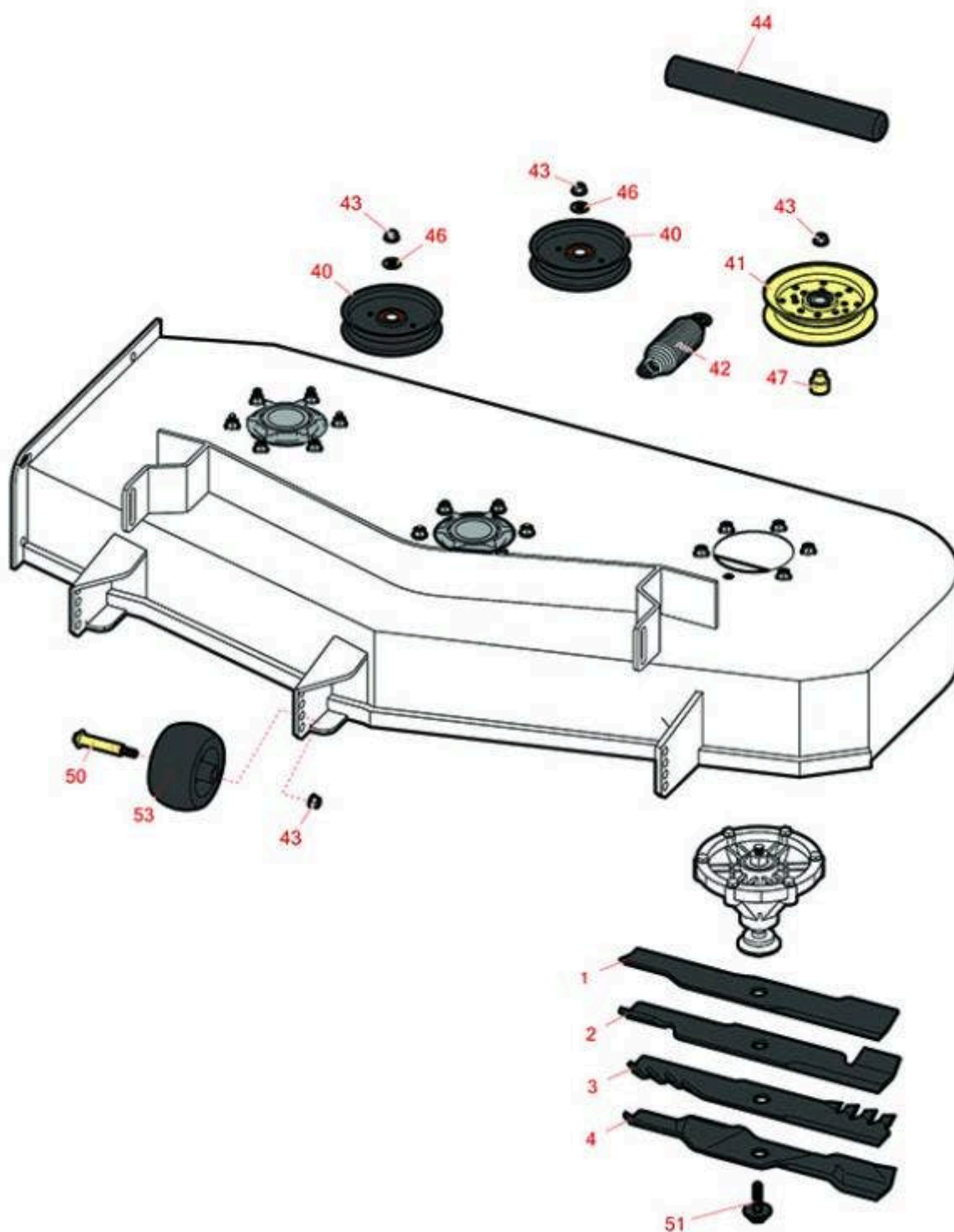

Replaces Exmark Quest Drive Series Parts

48in Rotary Mower
48in Deck Parts



All original equipment manufacturers names and part numbers are used for identification purposes only, and we are in no way implying that our products are original equipment parts. Prices subject to change without notice.



Replaces Exmark Quest Drive Series Parts

48in Rotary Mower
48in Deck Parts



Item No	R&R Part No.	OEM Part No.	Description	Qty Req	Order Quantity
---------	--------------	--------------	-------------	---------	----------------

Rotary Blades

1	R103-6386	103-6386	Mower Blade - 16-1/4 Low Lift	3	
2	R103-6401	103-6401	Mower Blade- Notched 16 1/4	3	
2	RRB3062-1601	103-6401, 103-6401-S	Mower Blade - High-Lift 16.25 x 2.5in x 15/16 Mt Hole	3	

Detail Description: R&R Products rotary blades are manufactured in the USA with superior alloy steel and hardened for extended life. Lifetime guaranteed against defects in material and workmanship.:

3	RRB4062-1601	116-5177, 116-5177-S	Mower Blade - Mulcher 16.25 x 2.5in x 15/16 Mt Hole	3	
4	RRB5360-1608	103-6391, 103-6391-S	Mower Blade - Wave Mulcher 16.25 x 2.5in x 15/16 Mt Hole	3	

Other Parts Available

40	R1-613098	1-613098	Pulley- Idler	2	
41	R126-9196	126-9196	Idler Pulley - Flat	1	
42	R116-6317	116-0133, 116-6317	Spring - Extension	1	
43	R104-8301	104-8301, 109-6658	Locknut - 3/8-16 Nylon Flanged	15	
44	R121-0726	121-0726	Grip - Foam	2	
46	R80-6990	80-6990	Washer - Hardened	2	
47	R138-7227	138-7227	Bushing - Idler	1	
50	R112-3977	112-3977	Bolt- Shoulder	3	
51	R116-0005	116-0005	Bolt- Blade, - Sems 7/16-20	3	
53	R68-2730	1-603299	Wheel - Anti Scalp	3	

All original equipment manufacturers names and part numbers are used for identification purposes only, and we are in no way implying that our products are original equipment parts. Prices subject to change without notice.