

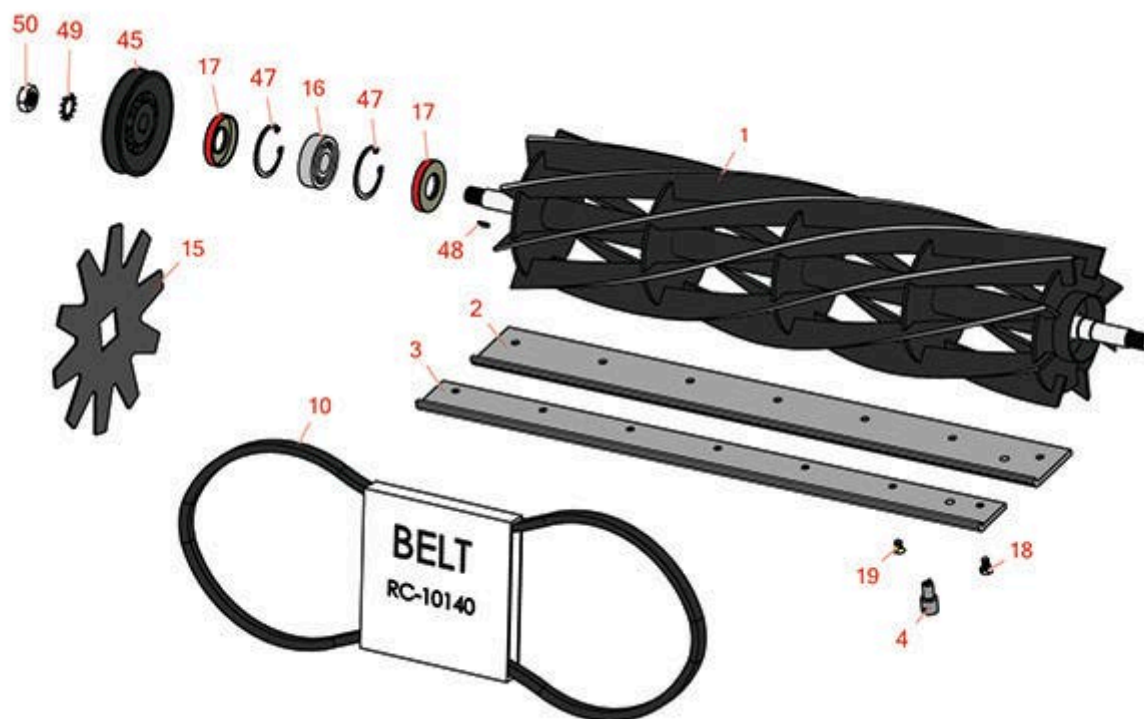

Cutting Unit

Reel & Bedknife



All original equipment manufacturers names and part numbers are used for identification purposes only, and we are in no way implying that our products are original equipment parts. Prices subject to change without notice.



Replaces Brouwer 3/5/7 Gang Mower

Parts

Cutting Unit

Reel & Bedknife



| Item No | R&R Part No. | OEM Part No. | Description | Qty Req | Order Quantity |
|---------|--------------|--------------|-------------|---------|----------------|
|---------|--------------|--------------|-------------|---------|----------------|

R&R Reels, Lifetime Guaranteed

| | | | | |
|---|----------------|--------|----------------|---|
| 1 | R101296 | 101296 | Reel - 5 Blade | 1 |
|---|----------------|--------|----------------|---|

Detail Description: R&R Reel blades are manufactured from high carbon-boron alloy steel and then hardened to RC46-49 to match the temper of our bedknives and original equipment bedknives. All R&R Reels are cylindrically ground on bearing surfaces and then relief ground. Reels are then precision computer balanced for extended bearing and reel life. R&R Products Reels are guaranteed against defects in material and workmanship for the life of the reel under normal use.:

| | | | | |
|---|----------------|--------|----------------|---|
| 1 | R101297 | 101297 | Reel - 6 Blade | 1 |
|---|----------------|--------|----------------|---|

Detail Description: R&R Reel blades are manufactured from high carbon-boron alloy steel and then hardened to RC46-49 to match the temper of our bedknives and original equipment bedknives. All R&R Reels are cylindrically ground on bearing surfaces and then relief ground. Reels are then precision computer balanced for extended bearing and reel life. R&R Products Reels are guaranteed against defects in material and workmanship for the life of the reel under normal use.:

| | | | | |
|---|----------------|--------|----------------|---|
| 1 | R101916 | 101916 | Reel - 8 Blade | 1 |
|---|----------------|--------|----------------|---|

Detail Description: R&R Reel blades are manufactured from high carbon-boron alloy steel and then hardened to RC46-49 to match the temper of our bedknives and original equipment bedknives. All R&R Reels are cylindrically ground on bearing surfaces and then relief ground. Reels are then precision computer balanced for extended bearing and reel life. R&R Products Reels are guaranteed against defects in material and workmanship for the life of the reel under normal use.:

R&R Bedknives, Lifetime Guaranteed

| | | | | |
|---|----------------|--|----------|---|
| 2 | R600215 | | Bedknife | 1 |
|---|----------------|--|----------|---|

Detail Description: R&R Bedknives are manufactured from high carbon-boron alloy steel and then hardened to RC46-49 to match the temper of our reel blades and original equipment reels. Bedknives are surface ground on the top and front edge and straightened three times before being packaged with oil for rust prevention. All R&R Bedknives now have an increased front edge grind for added life. All R&R Bedknives are guaranteed against defects in material and workmanship under normal use for the life of the part.:

| | | | | |
|---|----------------|--------|----------|---|
| 2 | R101074 | 101074 | Bedknife | 1 |
|---|----------------|--------|----------|---|

All original equipment manufacturers names and part numbers are used for identification purposes only, and we are in no way implying that our products are original equipment parts. Prices subject to change without notice.



Replaces Brouwer 3/5/7 Gang Mower

Parts

Cutting Unit

Reel & Bedknife



| Item No | R&R Part No. | OEM Part No. | Description | Qty Req | Order Quantity |
|---------|--------------|--------------|-------------|---------|----------------|
|---------|--------------|--------------|-------------|---------|----------------|

Detail Description: R&R Bedknives are manufactured from high carbon-boron alloy steel and then hardened to RC46-49 to match the temper of our reel blades and original equipment reels. Bedknives are surface ground on the top and front edge and straightened three times before being packaged with oil for rust prevention. All R&R Bedknives now have an increased front edge grind for added life. All R&R Bedknives are guaranteed against defects in material and workmanship under normal use for the life of the part.:

| | | | | | |
|---|----------------|--------|----------|---|--|
| 3 | R601091 | 601091 | Bedknife | 1 | |
|---|----------------|--------|----------|---|--|

Detail Description: R&R Bedknives are manufactured from high carbon-boron alloy steel and then hardened to RC46-49 to match the temper of our reel blades and original equipment reels. Bedknives are surface ground on the top and front edge and straightened three times before being packaged with oil for rust prevention. All R&R Bedknives now have an increased front edge grind for added life. All R&R Bedknives are guaranteed against defects in material and workmanship under normal use for the life of the part.:

| | | | | | |
|---|-----------------|--|--------------------|---|--|
| 3 | R601091L | | Bedknife - Low Cut | 1 | |
|---|-----------------|--|--------------------|---|--|

Detail Description: R&R Bedknives are manufactured from high carbon-boron alloy steel and then hardened to RC46-49 to match the temper of our reel blades and original equipment reels. Bedknives are surface ground on the top and front edge and straightened three times before being packaged with oil for rust prevention. All R&R Bedknives now have an increased front edge grind for added life. All R&R Bedknives are guaranteed against defects in material and workmanship under normal use for the life of the part.:

| | | | | | |
|---|----------------|--|----------|---|--|
| 3 | R600220 | | Bedknife | 1 | |
|---|----------------|--|----------|---|--|

Detail Description: R&R Bedknives are manufactured from high carbon-boron alloy steel and then hardened to RC46-49 to match the temper of our reel blades and original equipment reels. Bedknives are surface ground on the top and front edge and straightened three times before being packaged with oil for rust prevention. All R&R Bedknives now have an increased front edge grind for added life. All R&R Bedknives are guaranteed against defects in material and workmanship under normal use for the life of the part.:

Service Tools

| | | | | | |
|---|-----------------|--|----------------------------|---|--|
| 4 | R51-0880 | | Bedknife Screw Driver Tool | 0 | |
|---|-----------------|--|----------------------------|---|--|

Detail Description: Easily install and remove bed knife screws with the help of a ratchet with 3/8" drive. Tool manufactured with hardened alloy steel.:

Belts

| | | | | | |
|----|-----------------|---------|--------------------------|---|--|
| 10 | RC-10140 | C-10140 | Belt - V Secondary Drive | 1 | |
|----|-----------------|---------|--------------------------|---|--|

All original equipment manufacturers names and part numbers are used for identification purposes only, and we are in no way implying that our products are original equipment parts. Prices subject to change without notice.



Replaces Brouwer 3/5/7 Gang Mower

Parts

Cutting Unit
Reel & Bedknife



| Item No | R&R Part No. | OEM Part No. | Description | Qty Req | Order Quantity |
|---------|--------------|--------------|-------------|---------|----------------|
|---------|--------------|--------------|-------------|---------|----------------|

Blades

| | | | | | |
|----|---------|--------|---------------------------------|---|--|
| 15 | R102133 | 102133 | Verti-Cut Blade - 10 Dia x .104 | 0 | |
|----|---------|--------|---------------------------------|---|--|

Other Parts Available

| | | | | | |
|----|----------|---------|--------------------------------|---|--|
| 16 | RC-10013 | C-10013 | Bearing - Reel | 2 | |
| 17 | RC-10015 | C-10015 | Seal - Reel | 4 | |
| 18 | RC-10023 | C-10023 | Bolt - Bed Knife | 7 | |
| 19 | R150477 | | Screw - Bedknife 5/16-18 x 1/2 | 7 | |

Tech Note: Fits R600215 & R600220 Bedknives Only:

| | | | | | |
|----|----------|-------------------|--------------------------------|---|--|
| 45 | RC-10313 | C-10313 | Pulley - Reel | 1 | |
| 47 | RC-10014 | C-10014, G1002 | Ring - Retaining Fits Reel Brg | 4 | |
| 48 | R1164 | M-01-D-1164 | Key - 1/4 x 1/4 x 1 | 1 | |
| 49 | RC-10012 | C-10012 | Washer - Lock 3/4 Ext Tooth | 2 | |
| 50 | R3220-7 | C-10011, F7005 | Nut - 3/4-16 Jam Zinc | 2 | |

All original equipment manufacturers names and part numbers are used for identification purposes only, and we are in no way implying that our products are original equipment parts. Prices subject to change without notice.