

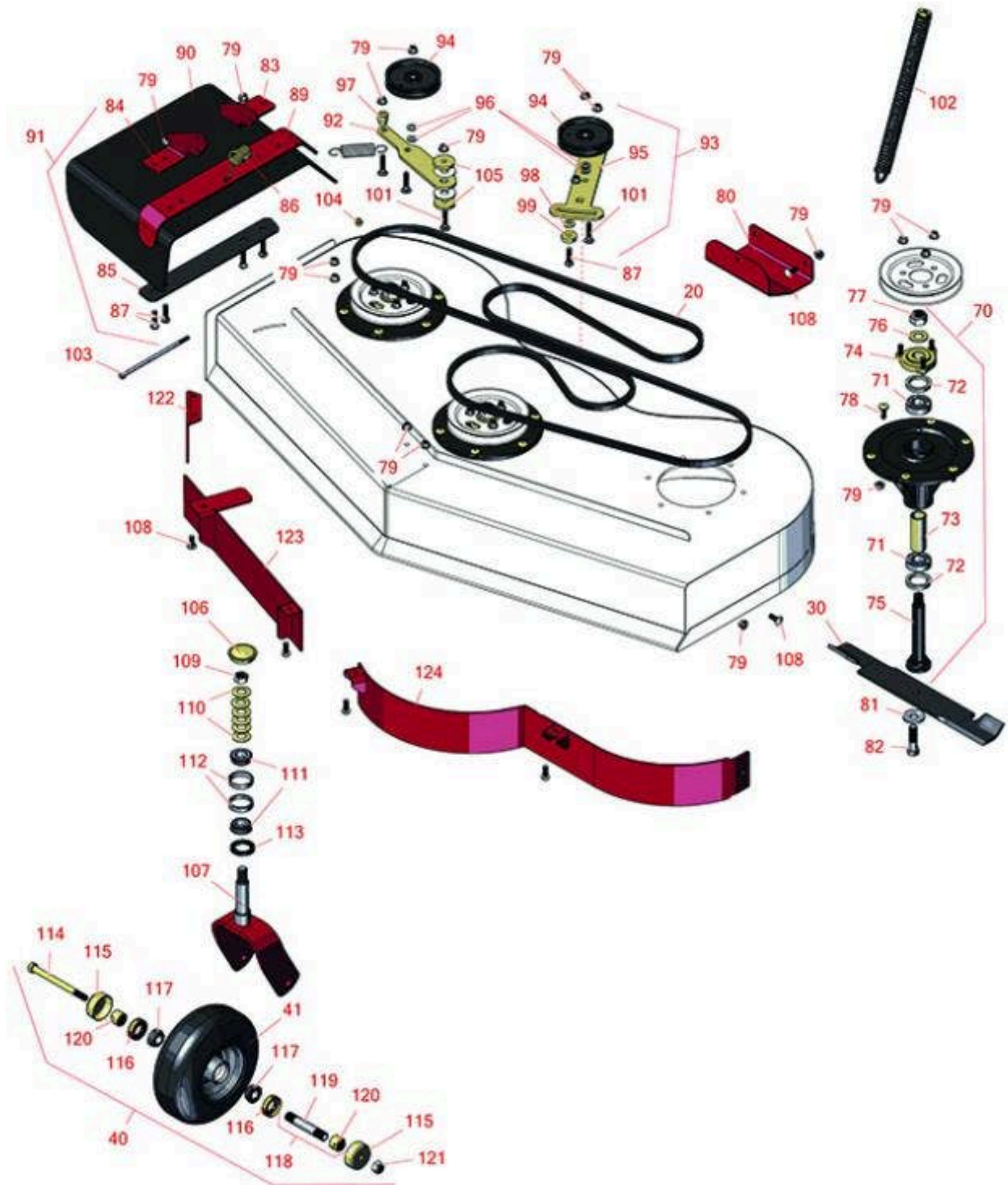

# Replaces Toro GrandStand Mower Parts

Mower with 52in Deck - Models 74575

52in Deck Parts



All original equipment manufacturers names and part numbers are used for identification purposes only, and we are in no way implying that our products are original equipment parts. Prices subject to change without notice.



# Replaces Toro GrandStand Mower Parts

Mower with 52in Deck - Models 74575

52in Deck Parts



Item No	R&R Part No.	OEM Part No.	Description	Qty Req	Order Quantity
<b>Belts</b>					
20	<b>R114-0454</b>	114-0454	Belt - V - Deck	1	
<b>Rotary Blades</b>					
30	<b>R105-7781-03</b>	105-7781-03	Mower Blade - 18 in High-Flow	3	
30	<b>RRB3065-1802</b>	105-7781-03, 1056-7781-03	Mower Blade - High-Lift 18 x 2.5in x 5/8 Mt Hole	3	
30	<b>R108-1117</b>	108-1117	Mower Blade Kit - 18 in High-Flow Set/6	1	
<b>Tires</b>					
40	<b>R130-4558</b>	112-3810, 112-8310, 130-4558	Wheel-Tire and Bearing Assy	2	
41	<b>R130-4563</b>	110-9965, 130-4563	Wheel and Tire Assy	2	
<b>Other Parts Available</b>					
70	<b>R119-8560</b>	117-6157, 119-8560	Spindle Assy	3	
71	<b>R119-8558</b>	119-8558, 76-7500	Bearing - Ball - Special	6	
72	<b>R253-133</b>	253-133	Seal - Oil	6	
73	<b>R117-6184</b>	117-6184	Spacer	3	
74	<b>R117-6172</b>	117-6172	Spindle Hub Assy w/Studs	3	
75	<b>R119-8527</b>	119-1851, 119-8527	Spindle Shaft and Zerk Assy	3	
76	<b>R92-5836</b>	92-5836	Flat Washer - Hardened	3	
77	<b>R3296-67</b>	3296-67	Locknut - 3/4-16 Heavy Jam RH Thread	3	

All original equipment manufacturers names and part numbers are used for identification purposes only, and we are in no way implying that our products are original equipment parts. Prices subject to change without notice.



# Replaces Toro GrandStand Mower Parts

Mower with 52in Deck - Models 74575

52in Deck Parts



Item No	R&R Part No.	OEM Part No.	Description	Qty Req	Order Quantity
78	<b>R114-8195</b>	114-8195, R & R ONLY	Bolt- Ribbed Neck	18	
79	<b>R104-8301</b>	104-8301, 104-9301, 109-6658, 133-7570	Locknut - 3/8-16 Nylon Flanged	41	
80	<b>R114-1908-01</b>	114-1908-01	Skid	1	
81	<b>R103-0865</b>	103-0865	Washer - Blade Bolt HD	3	
82	<b>R51-4060</b>	51-4060	Bolt - Blade	3	
83	<b>R108-4059-01</b>	108-4059-01	Plate-Hinge, Rear	1	
84	<b>R106-3253-01</b>	106-3253-01	Plate-Hinge, Front	1	
85	<b>R106-3248-03</b>	106-3248-03	Strap - Discharge	1	
86	<b>R108-4052</b>	108-4052	Spring - Torsion	1	
87	<b>R3231-4</b>	01-157-0440, 01-173-0612, 3231-4	Bolt - Carriage 3/8-16 x 1-1/2	6	
89	<b>R106-3246-01</b>	106-3246-01	Deflector	1	
90	<b>R151416</b>	108-5029, 110-0759, 151416	Deflector - Long	1	
91	<b>R120-2451</b>	120-2451, 121-5960	Deflector Assy	1	
92	<b>R120-6409</b>	120-6409	Idler Arm	1	
93	<b>R117-0446</b>	117-0446	Idler Adjust Assy	1	
94	<b>R93-1622</b>	93-1622	Idler Pulley - Flat 4 in Dia with .375 Bore	1	
95	<b>R114-1991</b>	114-1991	Plate- Idler	1	

All original equipment manufacturers names and part numbers are used for identification purposes only, and we are in no way implying that our products are original equipment parts. Prices subject to change without notice.



# Replaces Toro GrandStand Mower Parts

Mower with 52in Deck - Models 74575

52in Deck Parts



Item No	R&R Part No.	OEM Part No.	Description	Qty Req	Order Quantity
96	<b>R453011</b>	01-166-0100, 01-166-0120, 01-166-0270, 01-166-0500, 01-166-0600, 01-166-0620, 132-4593, 2356-3, 237-12, 24-10-AD, 24-11-AD, 24-11-BD, 24-12-AD, 24-12-BD, 30-9310, 32-8190, 3256-24, 3256-3, 3256-36, 3256-4, 453011, 47-9950, 48-9220, 513458, 7-0052	Washer - Flat 3/8 SAE Y/Zinc	3	
97	<b>R1-603496</b>	1-603496	Bushing - Idler	1	
98	<b>R98-5975</b>	98-5975	Washer - Belleville	1	
99	<b>R105-7788</b>	105-7788	Spacer .386" x 1 1/4" x .340"	1	
101	<b>R3231-5</b>	3231-5	Bolt - Carriage 3/8-16 x 1-3/4	1	
102	<b>R116-0886</b>	116-0886	Spring - Extension	2	
103	<b>R322-50</b>	322-50	Bolt - Hx HD 5/16-18 x 7 1/2	1	
104	<b>R104-8300</b>	104-8300, 104-8300, 119-4041	Locknut - 5/16-18 Flanged Y/Zinc	1	
105	<b>R110-9981</b>	110-9981	Washer-Plain	2	
106	<b>R103-4882</b>	103-4882	Grease Cap - Castor	2	

All original equipment manufacturers names and part numbers are used for identification purposes only, and we are in no way implying that our products are original equipment parts. Prices subject to change without notice.



# Replaces Toro GrandStand Mower Parts

Mower with 52in Deck - Models 74575

52in Deck Parts



Item No	R&R Part No.	OEM Part No.	Description	Qty Req	Order Quantity
107	<b>R121-7988-01</b>	121-7988-01	Fork - Caster	2	
108	<b>R3231-2</b>	01-157-0170, 01-173-0608, 3231-2, 3231-22, 3231-28, 900063P	Bolt - Carriage 3/8-16 x 1	5	
109	<b>R3296-51</b>	3296-51, 3296-81	Nut - Nylon Lock 3/4-10 Gr 8	2	
110	<b>R1-633508</b>	1-633508	Washer - Spring Disc	12	
111	<b>R254-94</b>	1-543509, 254-94, 32-8090, 32-8240, 32-9640, 40440, 62-3330	Tapered Bearing Cone	4	
112	<b>R254-72</b>	01-103-0050, 01-103-0120, 01-103-0140, 1-543508, 254-71, 254-72, 40439, 62-3340, 99-4511	Cup - Bearing	4	
113	<b>R116-5647</b>	116-5647	Seal - Grease	2	
114	<b>R325-20</b>	01-150-1250, 01-178-0848, 325-20	Bolt - Hx HD 1/2-13 x 6	2	
115	<b>R103-2768</b>	103-2768	Guard - Seal	4	
116	<b>R103-0063</b>	103-0063	Seal - Grease	4	

All original equipment manufacturers names and part numbers are used for identification purposes only, and we are in no way implying that our products are original equipment parts. Prices subject to change without notice.



# Replaces Toro GrandStand Mower Parts

Mower with 52in Deck - Models 74575

52in Deck Parts



Item No	R&R Part No.	OEM Part No.	Description	Qty Req	Order Quantity
117	<b>R254-78</b>	01-102-0060, 01-102-0130, 1-633585, 254-78, 32-7790, 32-9580, 93-4813	Tapered Bearing Cone	4	
118	<b>R126-5359</b>	126-5359	Caster Axle Assy w/Bushing	2	
119	<b>R103-3157</b>	103-3157	Axle - Caster Wheel	2	
120	<b>R103-3051</b>	103-3051	Spacer - Nut - Hardened	4	
121	<b>R3296-25</b>	30-3380, 32127-21, 32127-31, 3290-160, 3290-33, 3296-13, 3296-25, 3296-45, 329645	Locknut - 1/2-13 Heavy ESNA	2	
122	<b>R106-3216-01</b>	106-3216-01	Baffle - Discharge	1	
123	<b>R121-1790-01</b>	121-1790-01	Baffle	1	
124	<b>R114-1979-01</b>	114-1979-01	Baffle - 52 Inch	1	

All original equipment manufacturers names and part numbers are used for identification purposes only, and we are in no way implying that our products are original equipment parts. Prices subject to change without notice.